

TECHNICAL SPECIFICATIONS

Materials	Made of stainless steel
	The customer is responsible for marking out the work surface.
Materials	Type of materials used*: marble, wood, quartz, granite, belenco, caesar stone, dektion, corian, silverstone or lava stone (thickness required: between 4 and 20mm).
Dimensions	340mm x 340mm overall fixing
Power	650W
Controls	Remote touch-sensitive keypad
Amperage	3A
Functions	Controlled by a remote 3-key keypad with 4-digit display.
Induc-stone	20 levels of settings available. (Product available with timer in control panel version without stainless steel frame)
Power supply	220-240V Single-phase 50-60Hz 120V version available
Weight	4.8 kg
Standards	Complies with European safety standards for electrical appliances.
Kit composition	<ul style="list-style-type: none"> - 1 heating block, to be fitted by the customer under the worktop - 1 Power cord 1M80 - 1 Spacer - 1 remote control (2M) for flush-mounting by the customer (Remote control communication cables available in 4, 5 or 8M)

*Contact us if you wish to use another type of material.

ADVENTYS
Route de Pagny - 21250 Seurre - France
www.adventys.com
contact@adventys.com
T: 03.80.20.46.15

Importante Note
Adventys reserves the right to change specifications without notice.

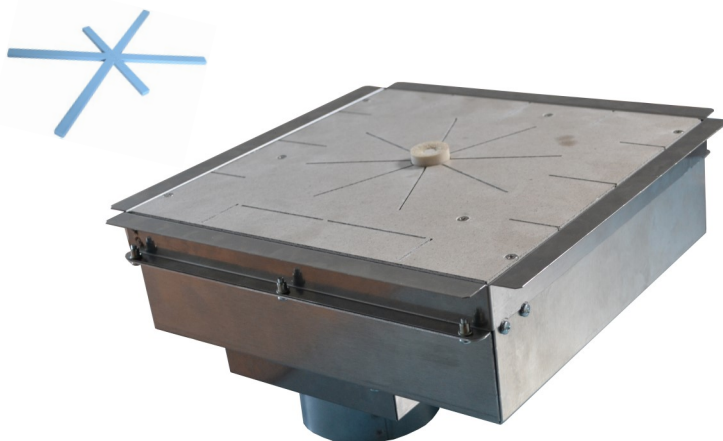

Induc-stone special features

The induc-stone is a device that heats a chafing dish to keep food at the desired temperature. Positioned under your worktop, it is invisible, offering a safe and economical solution thanks to induction technology.



How to use it ?

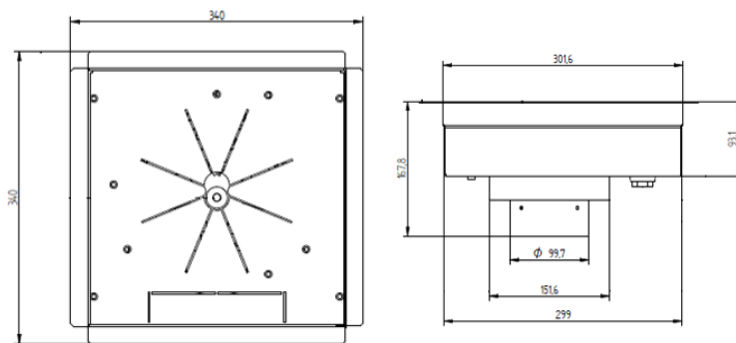

Stainless steel frame control panel
Installation dimensions 198x68mm

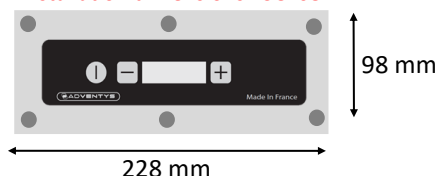

Frameless control panel version / with timer
Built-in dimensions control 48x163mm

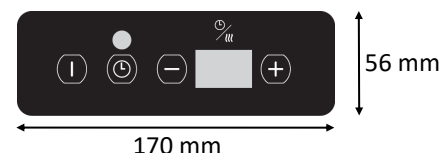

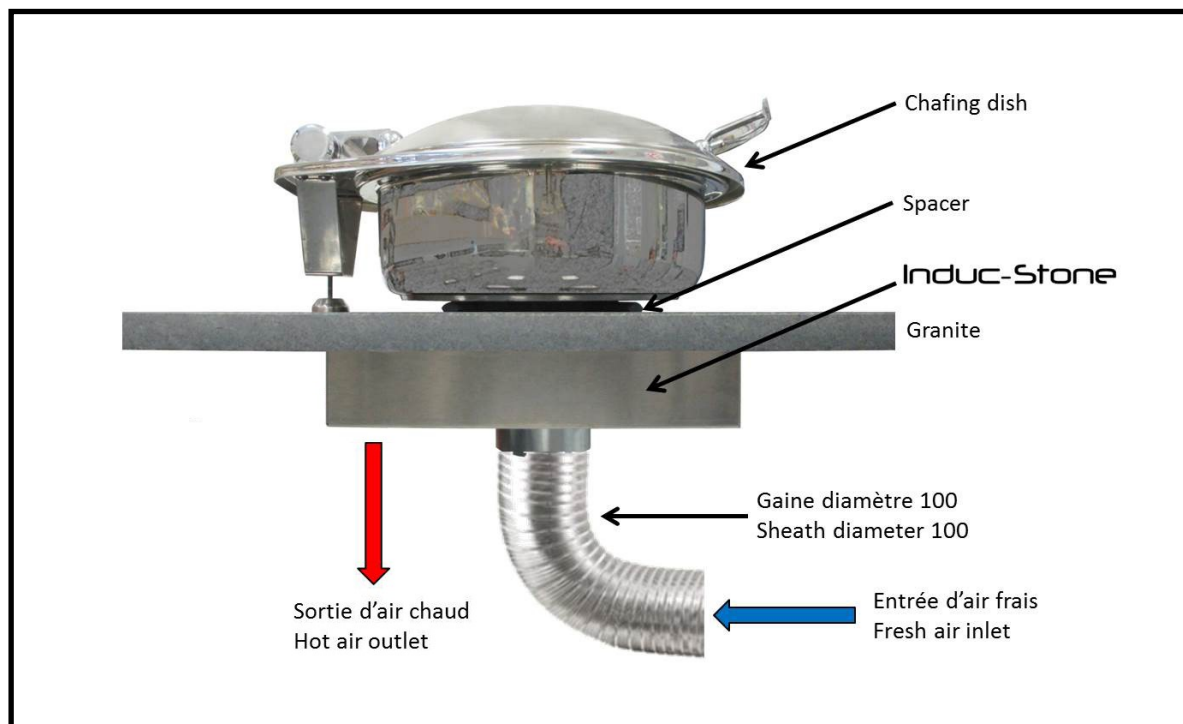

- 1) Leave a distance of at least 20 mm between the edge of the top and the edge of the kit, and between 2 kits (see drawing on next page).
- 2) The thickness of the material should be between 4 and 20 mm.
- 3) It is preferable to supply fresh air to the induction kit via a duct connected to the kit funnel provided for this purpose.
- 4) During installation, make sure that the kit's temperature sensor makes contact with the surface material.
- 5) Make sure the installation has good ventilation to allow hot air to escape from the kit.

ADVENTYS
 Route de Pagny - 21250 Seurre - France
www.adventys.com
contact@adventys.com
 T: 03.80.20.46.15

Importante Note
 Adventys reserves the right to change specifications without notice.

Suggested layout

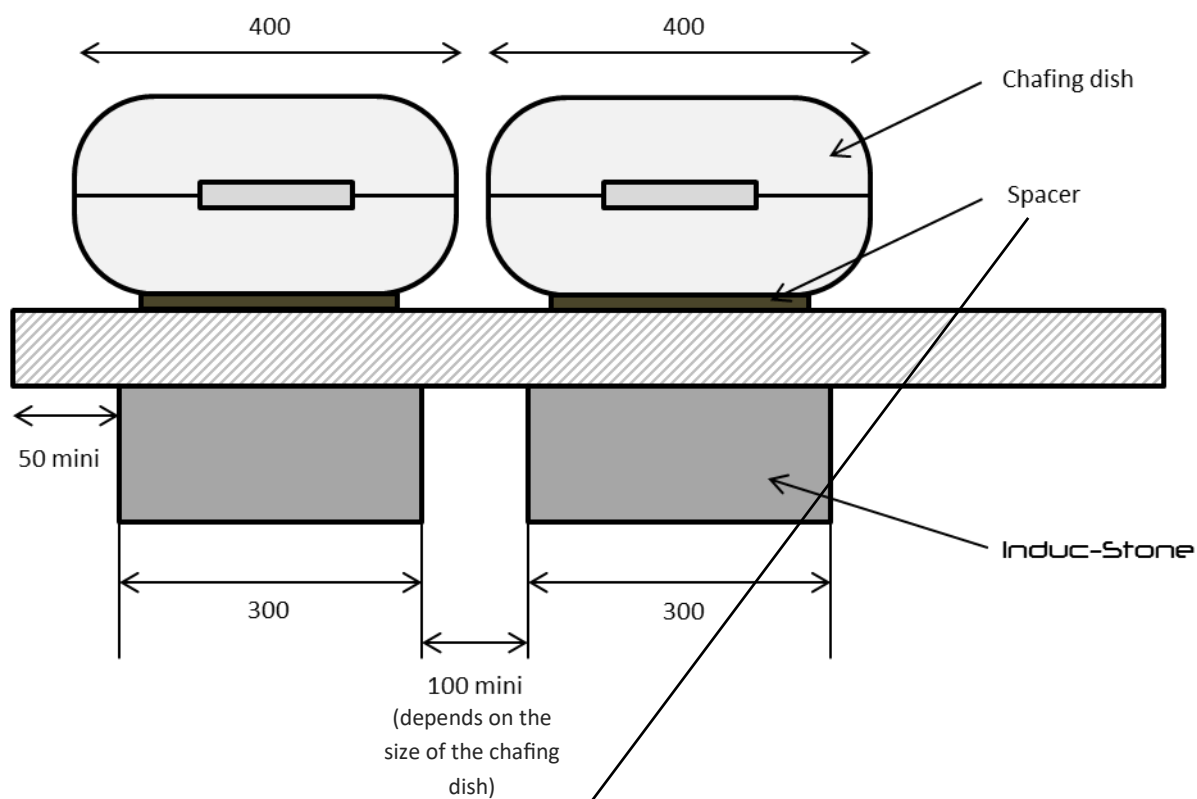

Spacer version big chafing dish

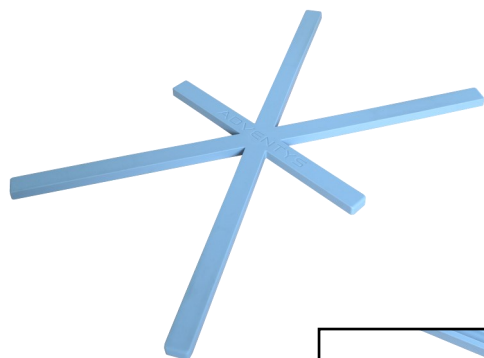

Spacer version small chafing dish

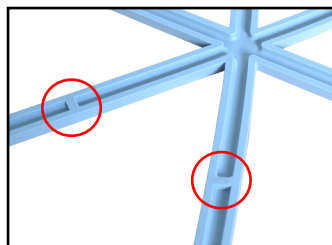
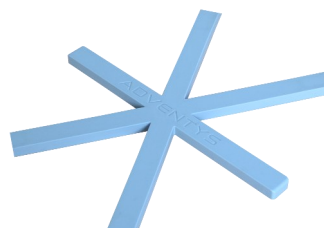

Cut your spacer at the circled sections to obtain a small chafing dish version.

ADVENTYS

Route de Pagny - 21250 Seurre - France

www.adventys.com

contact@adventys.com

T: 03.80.20.46.15

Importante Note

Adventys reserves the right to change specifications without notice.

Heater block dimensions

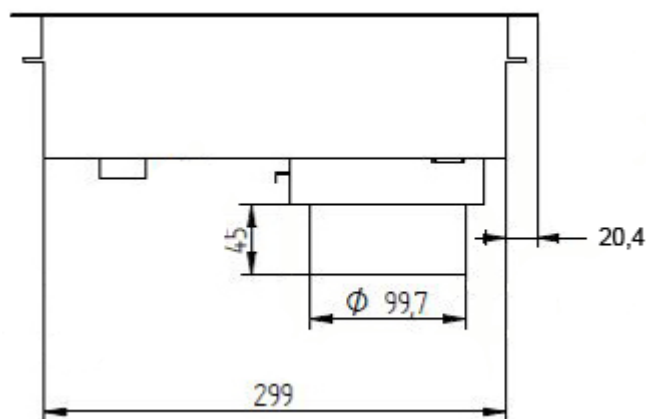
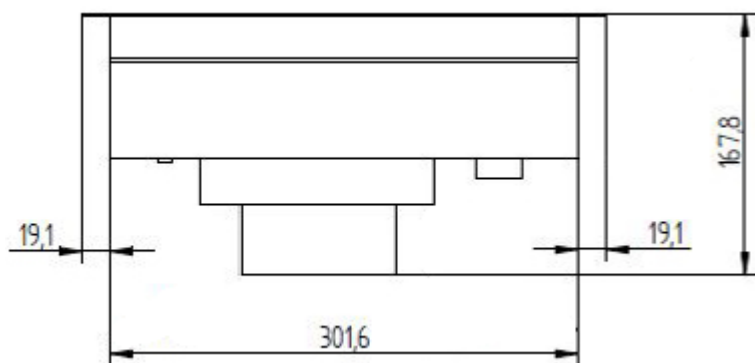
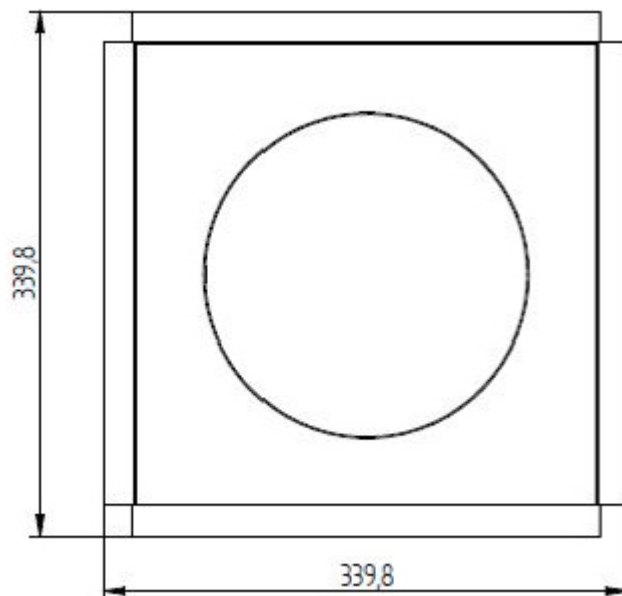
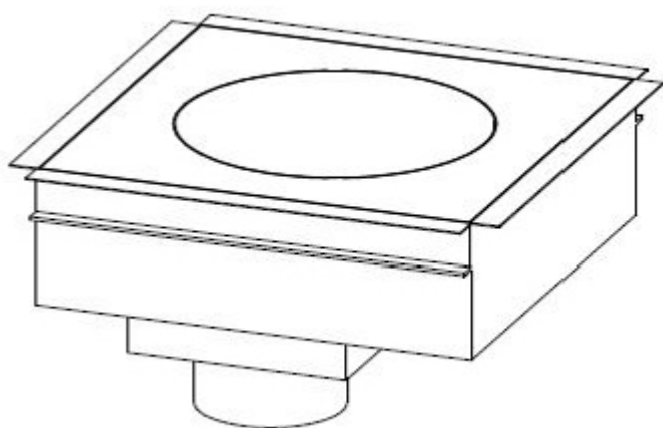

ADVENTYS
Route de Pagny - 21250 Seurre - France
www.adventys.com
contact@adventys.com
T: 03.80.20.46.15

Importante Note
Adventys reserves the right to change specifications without notice.

Control panel dimensions

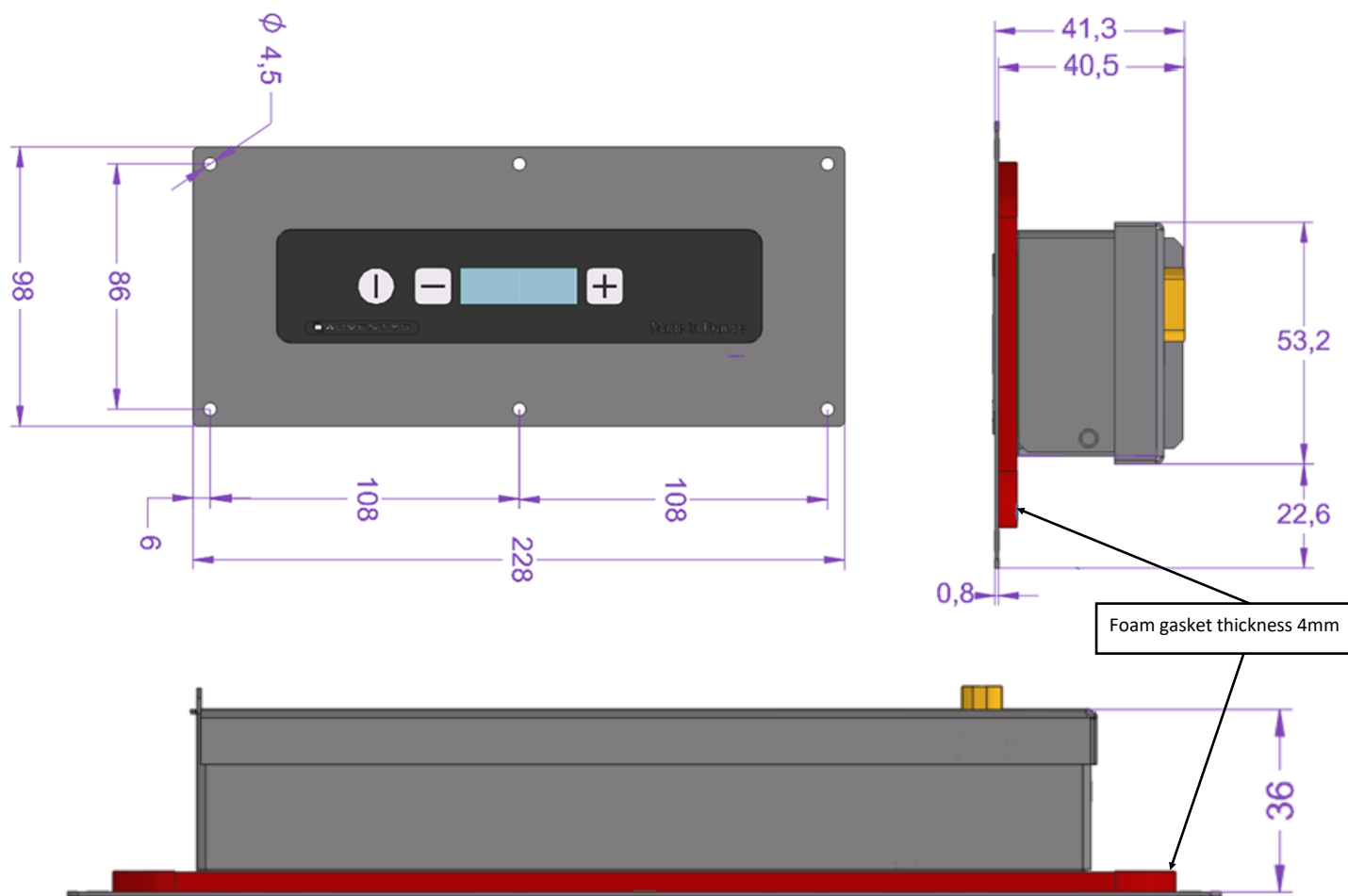

Cut-out dimensions for control panel integration

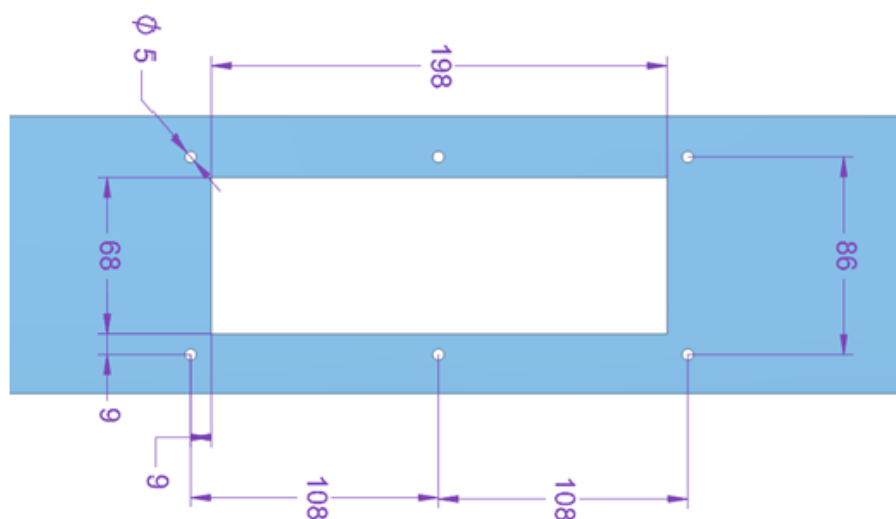

ADVENTYS
 Route de Pagny - 21250 Seurre - France
www.adventys.com
contact@adventys.com
 T: 03.80.20.46.15

Importante Note
 Adventys reserves the right to change specifications without notice.

