

CIM 175/75 - CIM 175 - CIM 300

PRODUTTORI GHIACCIO CUBETTO PIENO - FULL CUBE ICE MAKERS

MACHINES À GLACE GLAÇONS PLEIN - FABRICADORES HIELO EN CUBITOS MACIZOS



175/300 kg/24 h

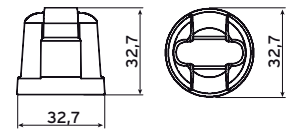

Cubetto / Cube / Glaçons / Cubitos
18 gr



CIM 175 - CIM 300

CIM 175/75

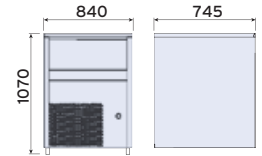

CIM 175/75

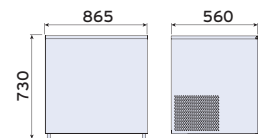

CIM 175

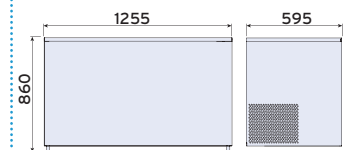

CIM 300



- Costruzione in acciaio inox e materiali idonei al contatto con gli alimenti
- **Vasca raccolta ghiaccio integrata per CIM 175/75**
- Gas R404a
- Condensazione (A) aria o (W) acqua
- Controlli elettronici
- Voltaggi speciali, su richiesta
- Macchine rispondenti alle normative di igiene e di sicurezza in vigore
- **Condizioni di lavoro standard:**
temperatura acqua 15°C
temperatura ambiente 20°C
- Consigliata installazione sistema dosatore sale anticalcare



- Construction in stainless steel and specific materials approved for contact with food stuff
- **Built-in ice collection tank for CIM 175/75**
- Gas R404a
- (A) Air or W (Water) condensing
- Electronic controls
- Special voltages, on request
- Machines comply with hygiene and safety regulations
- **Standard working conditions:**
incoming water temperature 15°C
environment air temperature 20°C
- Highly recommended the installation of salt dosing unit to prevent scale built-up of limestone



- Construction en acier inox et matériaux pour aliments
- **Bac de récupération de la glace intégré pour CIM 175/75**
- Gaz R404a
- Condensation (A) air ou (W) eau control électronique
- Tensions spéciales, sur demande
- Machines conformes aux normes en vigueur en matière d'hygiène et de sécurité
- **Conditions de travail standard:**
température eau 15°C
température environnement 20°C
- Une unité de dosage de poudre pour empêcher le calcaire est fortement recommandée



- Estructura de acero inoxidable y materiales para alimentos
- **Cuba colectora de hielo integrada en CIM 175/75**
- Gas R404a
- Comandos electrónicos condensación (A) aire o (W) agua
- Voltajes especiales a petición
- Máquinas conformes a las normas vigentes en materia de higiene y seguridad
- **Condiciones de trabajo standards:**
temperatura entrada agua: 15°C
temperatura ambiente: 20°C
- Recomendado instalación sistema dosificador de sales para evitar incrustaciones de calcio

	CIM 175/75	CIM 175	CIM 300
Produzione - Productivity Production - Producción	175 Kg/24 h 10294 cubetti/cubes/glaçon/cubitos	175 kg/24 h 10294 cubetti/cubes/glaçon cubitos	300 kg/24 h 17650 cubetti/cubes/glaçon/cubitos
Capacità deposito - Storage capacity Capacite bac - Capacidad depósito	75 kg 4411 cubetti/cubes/glaçon/cubitos approx	-	-
Potenza elettrica - Electrical Power Puissance électrique - Potencia eléctrica	1,7 kW	1,7 kW	2,7 kW
Peso netto - Net weight - Poids net - Peso neto	113 kg	97 kg	153 kg
Tensione nominale - Volt Rated Tension nominale - Tensión nominal	V230/1/50Hz	V230/1/50Hz (*)	V230/1/50Hz (*)

ACCESSORI - ACCESSORIES - ACCESSOIRES - ACCESORIOS (pag. 27-30)



(*) CIM 175-CIM 300: fornite senza pulsante START/STOP (eventuale adeguamento impianto del cliente non incluso) - CIM 175-CIM 300: not included START/STOP switch (eventual adaptation on electrical box is not included) - CIM 175-CIM 300: non inclus Commutateur START / STOP (l'adaptation éventuelle sur panneau électrique n'est pas incluse) / CIM 175-CIM 300: sin pulsante START/STOP (eventual adaptación cuadro eléctrico del cliente no incluida)