

Asian Cooking - Wok Range

Gas - Wok Kwalie

NGK 7-90



Due to continuous technical development, the image shown may not represent the latest design of the unit.

DESCRIPTION

Single gas wok with a high-performance, low-pressure jet-burner and a power rate of 33 kW. Compact, powerful and suitable for various methods of Asian cooking, the NGK low-pressure wok is the perfect choice for any kitchen.

Made of stainless steel AISI 304 with a deep drawn 1.2 mm strong, reinforced (1 mm) top panel and a heavy-duty removable cast iron wok rings. Cold-water supply with one swivel faucet mounted on the backsplash, easily operable from the front panel.

The intelligent deck cooling & cleaning system with spray nozzles guarantee efficient cooling of the top panel and enhanced hygiene as food debris is flushed away towards the drain channel in the back. The built-in strainer avoids the congestion of the drain.

OTHER AVAILABLE MODELS

- NGK 15-90
- NGK 22-90

MAIN FEATURES

- One atmospheric, low-pressure jet-burner with a power rate of 33 kW.
- Manual ignition.
- Equipped with pilot burner, safety thermocouple, gas valve, gas knee lever.
- Slanted, deep drawn stainless steel top panel AISI 304 (1.2 mm) with stainless steel reinforcement (1 mm) and a drain channel with a removable strainer in the front.
- Cold-water supply with one swivel faucet mounted on the backsplash.
- Deck cooling & cleaning system with spray nozzles for maximum hygiene.
- Suitable for wok-pan sizes Ø 14-18" (355-457 mm).

CONSTRUCTION

- Sturdy frame made of stainless steel AISI 430.
- Slanted, deep drawn stainless steel top panel AISI 304 (1.2 mm) with stainless steel reinforcement (1 mm) and hairline surface pattern.
- Front and side panels made of stainless steel AISI 430 with hairline surface pattern (0.8 mm).
- Backsplash made of stainless steel AISI 304 with hairline surface pattern (1.2 mm).
- Tubular, height adjustable (± 10 mm) stainless steel legs.
- Type of installation: free standing.
- Frame, top and panels, all made of high-grade stainless steel.

INCLUDED ACCESSORIES

- Wok stand (1 pc)

OPTIONAL ACCESSORIES

- Ladle / basket holder
- Condiment tray made of stainless steel AISI 304 (300x300 mm).

PT. NAYATI INDONESIA

www.nayati.com

Nayati reserves the right to make product alterations and or price adjustments at any time and can not be held responsible for any printing errors or omissions.

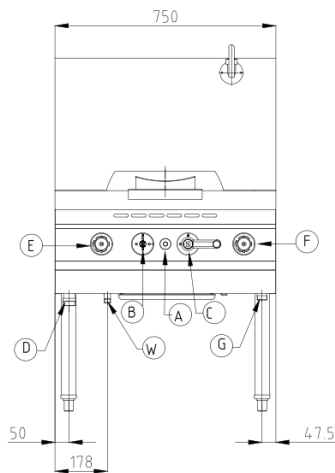
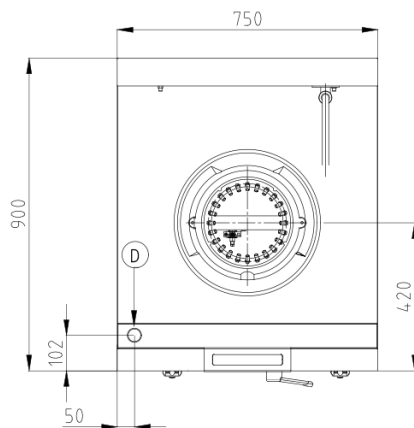
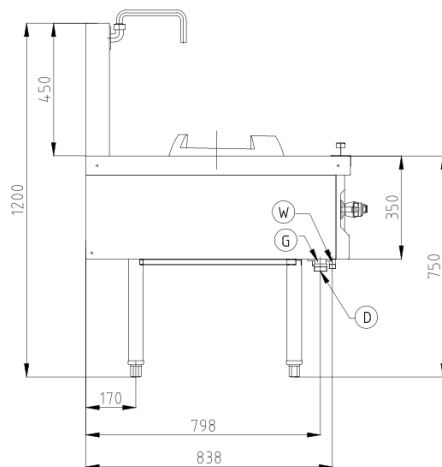
FRONT**TOP****SIDE**

*Overall dimension in mm

TECHNICAL DATA**External Dimensions**

Width	: 750 mm
Depth	: 900 mm
Height	: 750/1200 mm

Cooking Surface

Wok burners	: Ø 330 mm
Soup burners	: N/A

Gas Power Rating

Heat input total	: LPG/Natural Gas 33 kW
No. of burners	: 1
Control type	: Open-close valve
Gas type options	: LPG G30 Natural Gas G20

Connections

Gas	: DN25 (1")
Water	: DN15 (1/2")
Drain	: DN32 (1 1/4")

Heat & Steam Emissions

Direct heat emission	: LPG/Natural Gas 8.25 kW
Latent heat emission	: LPG/Natural Gas 4.95 kW
Steam emission	: LPG 8.75 kg/h

PACKAGING DATA

Width	: 800 mm
Depth	: 1020 mm
Height	: 1400 mm
Volume	: 1.14 m ³

WEIGHT

Net Weight	: 74 kg
Gross Weight	: 94 kg