



GENERAL FEATURES

- Rack dimensions: **50x50 cm**
- Net weight: 128 Kg
- Wash cycles / racks per hour: 60"-120"-180"-9' / 60-30-20-7
- Automatic cycle start upon door closure
- Stainless-steel wash/rinse arms easily removable
- Wash pump: 1 kW
- Boiler capacity: 11 lt
- Tank capacity: 30 lt
- Boiler heating element: 9 kW
- Tank heating element: 2,8 kW
- Water quantity per cycle: 2,5 liters
- Useful washing height: 415 mm
- Electronic management with color LCD display showing boiler and tank temperatures, multicolored start button and self-diagnostic system
- PRS System: built-in atmospheric boiler, independent from the water supply pressure, with rinse pump to guarantee constant rinse temperature and pressure throughout the entire rinse phase
- High efficiency air gap (A class)
- Double electric detergent and rinse aid dispenser
- Thermostop function (hot rinse)
- Green function for energy saving
- Automatic end of day self-cleaning cycle
- Self-cleaning vertical washing pump

WATER FILTRATION

- Pre-filtering of the tank water by means of stainless-steel filter
- Plastic wash pump filter, easily removable

BODY

- AISI 304 stainless-steel structure
- Single skinned hood
- Preformed wash tank with rounded corners to avoid grime build-up
- Hood opening system with springs
- Boiler in stainless-steel AISI 316

TECHNICAL DATA SHEET

Mod. HK 1200 EPI PRS

STANDARD EQUIPMENT

- 2 plate racks 50x50 cm
- 1 glass rack 50x50 cm
- 2 cutlery holders
- 1 inlet hose (length 2 mt)
- 1 drain hose (length 2 mt)

OPTIONS

- HD version (12,8 kW in 380-415V 3N~)
- Built-in automatic water softener (S)
- Drain pump (DP)
- Double skinned insulated hood (DSI)
- KIT remote control
- 60 Hz version

WATER TREATMENT ACCESSORIES

- Automatic water softener
- Reverse osmosis machine

ACCESSORIES

- Entry / exit tables in stainless-steel
- Pre-wash tables in stainless-steel
- Special racks

WATER SUPPLY CONNECTION

- **Water supply hardness:**
Water hardness between 0 and 14°F (0 ÷ 8°d)
Above 14°F (8°d) suggested water softener
- **Water supply dynamic pressure:**
Standard between 1 and 5 BAR
With built-in water softener between 1 and 4 BAR
- **Water supply temperature:**
Standard between 10 and 60°C
With built-in water softener between 10 and 25°C

MAIN POWER SUPPLY

- The voltage of main power supply must be compatible with the rated voltage
- The machine must be connected to a suitable earth (ground) system
- Connect the machine power socket to the multi-pole wall switch provided

TECHNICAL SPECIFICATIONS

- Electrical supply: **380-415V 3N / 220-240V3 / 220-240V~ 50 Hz (MULTIPOWER)**
- Total power: **10 kW (12,8 kW in HD)**
- Absorbed current: **18 A / 27 A / 31 A (25 A in HD)**
- Power cord supply size: **5 x 4 mm² / 3 x 4 mm²**

HK 1200 EPI PRS

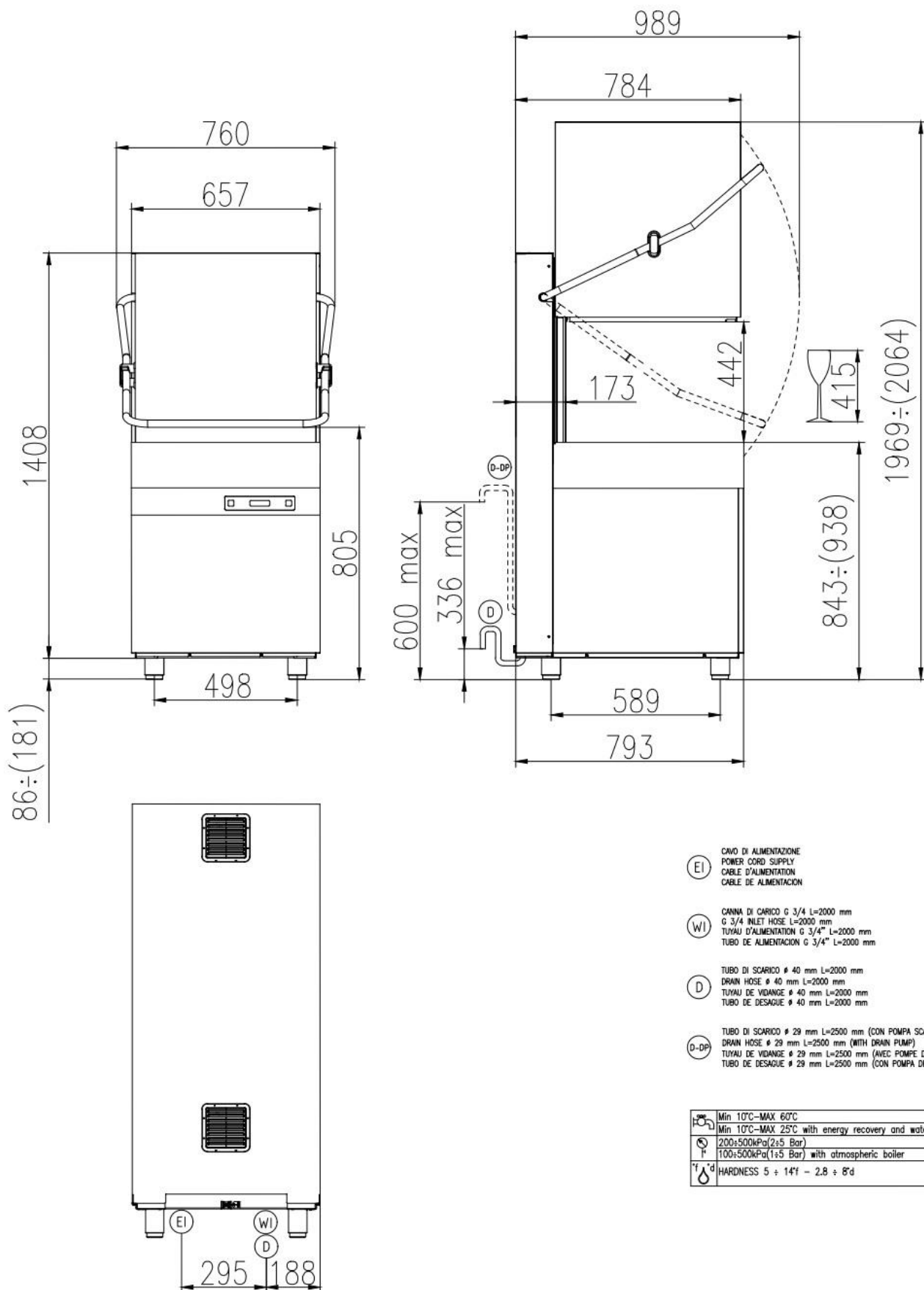

(EI) CAVO DI ALIMENTAZIONE
POWER CORD SUPPLY
CABLE D'ALIMENTATION
CABLE DE ALIMENTACION

(WI) CANNA DI CARICO G 3/4 L=2000 mm
G 3/4 INLET HOSE L=2000 mm
TUYAU D'ALIMENTATION G 3/4" L=2000 mm
TUBO DE ALIMENTACION G 3/4" L=2000 mm

(D) TUBO DI SCARICO Ø 40 mm L=2000 mm
DRAIN HOSE Ø 40 mm L=2000 mm
TUYAU DE VIDANGE Ø 40 mm L=2000 mm
TUBO DE DESAGUE Ø 40 mm L=2000 mm

(D-DP) TUBO DI SCARICO Ø 29 mm L=2500 mm (CON POMPA SCARICO)
DRAIN HOSE Ø 29 mm L=2500 mm (WITH DRAIN PUMP)
TUYAU DE VIDANGE Ø 29 mm L=2500 mm (AVEC POMPE DE VIDANGE)
TUBO DE DESAGUE Ø 29 mm L=2500 mm (CON POMPA DE DESAGUE)

Min 10°C-MAX 60°C
Min 10°C-MAX 25°C with energy recovery and water softener
200÷500kPa(2÷5 Bar)
100÷500kPa(1÷5 Bar) with atmospheric boiler
HARDNESS 5 ÷ 14°f - 2.8 ÷ 8°d