



#### GENERAL FEATURES

- Rack dimensions; **40x40 cm**
- Net weight: 44 Kg
- Wash cycles / racks per hour: 90"-120"-180"-9' / 40-30-20-7
- Composite material wash/rinse arms easily removable
- Wash pump: 330 W
- Boiler capacity: 4 lt
- Tank capacity: 12 lt
- Boiler heating element: 2,7 kW
- Tank heating element: 2,4 kW
- Water quantity per cycle: 2 lt
- Useful washing height: 290 mm
- Electronic management with 6-character LED display showing boiler and tank temperatures, multicoloured start button and self-diagnostic system
- PRS System: built-in atmospheric boiler, independent from the water supply pressure, with rinse pump to guarantee constant rinse temperature and pressure throughout the entire rinse phase
- High efficiency air gap (A class)
- Double electric detergent and rinse aid dispenser
- Thermostop function (hot rinse)
- Green function for energy saving
- Automatic end of day self-cleaning cycle

#### FILTRATION

- Plastic wash pump filter, easily removable

#### BODY

- AISI 304 stainless steel structure
- Partial double skinned body
- Preformed wash tank with rounded corners to avoid grime build-up
- Preformed rack guides
- Double walled door
- 30/10 door reinforcement brackets for extra strength
- Boiler in stainless-steel AISI 316

#### EQUIPMENT AS GLASSWASHER

- 2 glass racks 40x40 cm
- 1 cutlery holder
- 1 insert for 12 saucers
- 1 inlet hose (length 2 mt)
- 1 drain hose (length 2,5 mt)

#### OPTIONS

- Round basket equipment (RB)
- Built-in automatic water softener (S)
- Drain pump (DP)
- KIT surface filters
- KIT high feet (95÷140mm)
- 380-415V3N~50 Hz version (5,73 kW total power)
- 60 Hz version

#### WATER TREATMENT ACCESSORIES

- Automatic water softener
- Reverse osmosis machine

#### ACCESSORIES

- Stainless steel stand H 550 mm
- Special racks

#### WATER SUPPLY CONNECTION

- **Water supply hardness:**  
Water hardness between 0 and 14°f (0 ÷ 8°d)  
Above 14°f (8°d) suggested water softener
- **Water supply dynamic pressure:**  
Standard between 2 and 5 BAR  
With built-in water softener between 2 and 4 BAR
- **Water supply temperature:**  
Standard between 10 and 60°C  
With built-in water softener between 10 and 25°C

#### MAIN POWER SUPPLY

- The voltage of main power supply must be compatible with the rated voltage
- The machine must be connected to a suitable earth (ground) system
- Connect the machine power socket to the multi-pole wall switch provided

#### TECHNICAL SPECIFICATIONS

- Electrical supply: **220-240V~ 50 Hz**
- Total power: **3,03 kW**
- Absorbed current: **14 A**
- Power cord supply size: **3 x 2,5 mm<sup>2</sup>**

## FK 40 ESI LS PRS PA

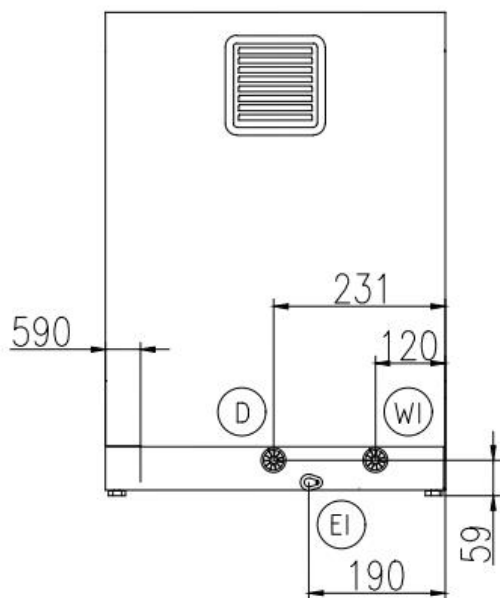
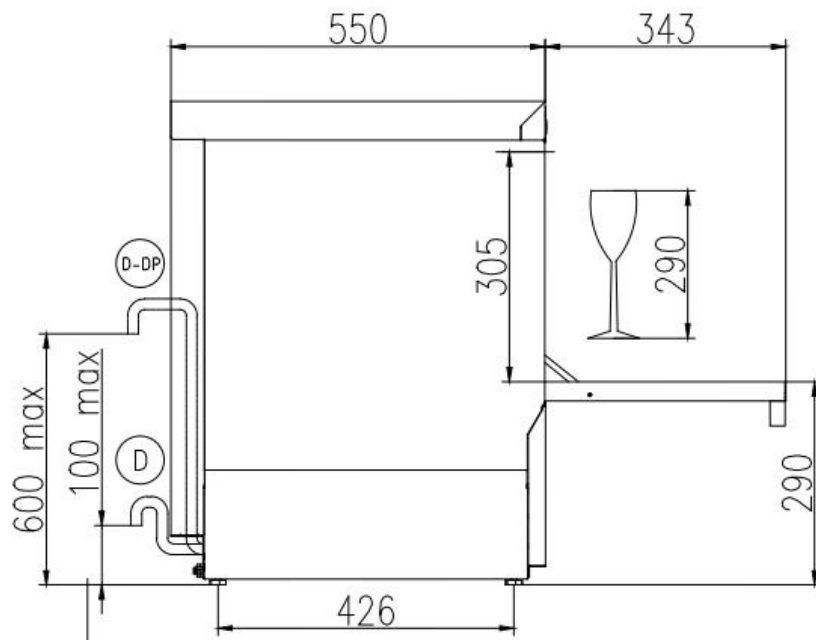
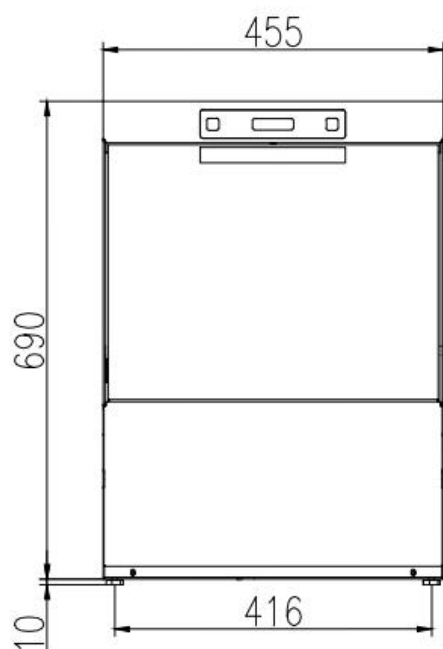

(EI) CAVO DI ALIMENTAZIONE  
 POWER CORD SUPPLY  
 CABLE D'ALIMENTATION  
 CABLE DE ALIMENTACION

(WI) CANNA DI CARICO G 3/4 L=2000 mm  
 G 3/4 INLET HOSE L=2000 mm  
 TUYAU D'ALIMENTATION G 3/4" L=2000 mm  
 TUBO DE ALIMENTACION G 3/4" L=2000 mm

(D) TUBO DI SCARICO Ø 29 mm L=2500 mm  
 DRAIN HOSE Ø 29 mm L=2500 mm  
 TUYAU DE VIDANGE Ø 29 mm L=2500 mm  
 TUBO DE DESAGUE Ø 29 mm L=2500 mm

(D-DP) TUBO DI SCARICO Ø 29 mm L=2500 mm (CON POMPA SCARICO)  
 DRAIN HOSE Ø 29 mm L=2500 mm (WITH DRAIN PUMP)  
 TUYAU DE VIDANGE Ø 29 mm L=2500 mm (AVEC POMPE DE VIDANGE)  
 TUBO DE DESAGUE Ø 29 mm L=2500 mm (CON POMPA DE DESAGUE)

Min 10°C-MAX 60°C
Min 10°C-MAX 25°C with energy recovery and water softner
200÷500kPa(2÷5 Bar)
100÷500kPa(1÷5 Bar) with atmospheric boiler
HARDNESS 5 ÷ 14°f - 2.8 ÷ 8°d